

Installation Instructions for 9600 Series Dummy Lever on Round Rosette and 9900 Series Dummy Lever on Square Backplate

9600 Series Dummy Lever on Round Rosette

Step 1.

- Remove rosette cover.

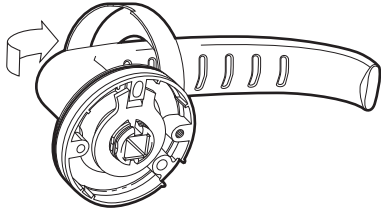

Step 2.

- Install blind headed screw **a** and post **b** through rosette hole closest to the door edge.

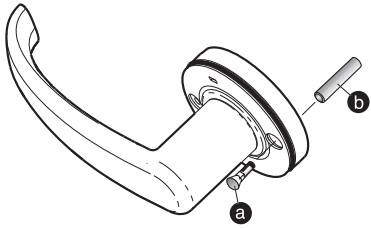

Step 3.

- Prepare door as indicated on the template below.
- Push screws through cup washers **c**.
- Install short screw **d** into the threaded post **e** and longer screw **f** into the threaded screw hole **g** in rosette.

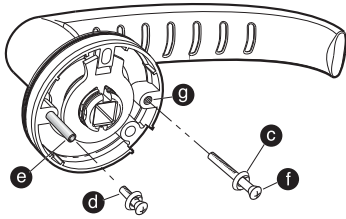

Step 4.

- Replace rosette cover.

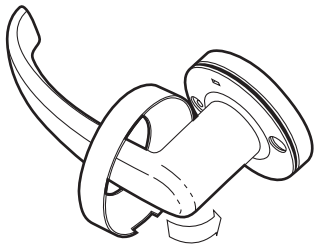

9900 Series Dummy Lever on Square Backplate

Step 1.

- Remove rosette cover.

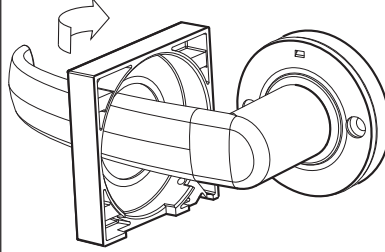

Step 2.

- Install blind headed screw **a** and post **b** through rosette hole closest to the door edge.

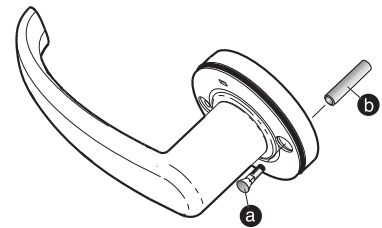

Step 3.

- Prepare door as indicated on the template below.
- Push screws through cup washers **c**.
- Install short screw **d** into the threaded post **e** and longer screw **f** into the threaded screw hole **g** in rosette.

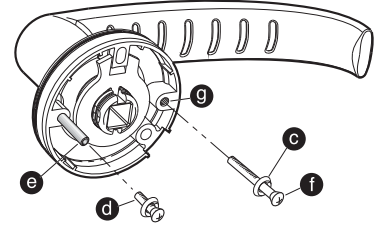

Step 4.

- Reapply rosette cover by pushing it over the rubber ring until flush with the door. The grub-screw, which is already located in the rosette cover, should be on the lower face.
- Check the cover is square with the door edge. Fasten in place with *grub-screw **h** using allen key **k** provided.

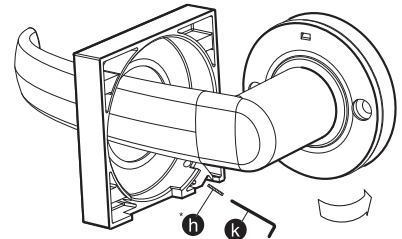

*Note: Grub-screw is already located in the rosette cover



NOTE: CAREFULLY FOLLOW THESE INSTRUCTIONS WHEN INSTALLING. DO NOT OVERTIGHTEN SCREWS. USE OF POWER DRIVER IS NOT RECOMMENDED. SCREWS TO BE TIGHTENED TO A RECOMMENDED 2.5NM TORQUE.

fit here on door edge

fit here on door edge

backset 70mm (2 3/4")

backset 60mm (2 3/8")

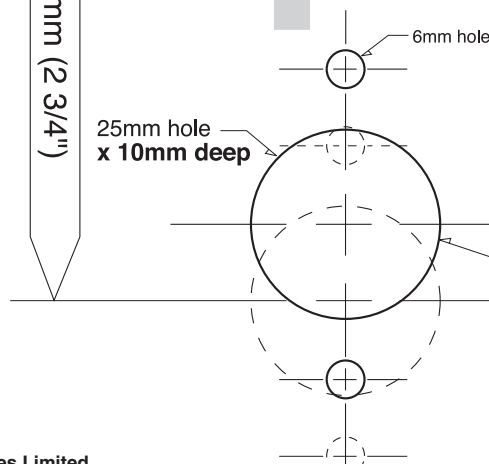

Important Note:
Do not drill this hole through the door!



Gainsborough Hardware Industries Limited,
Melbourne, Australia. A.B.N 25 004 792 269
www.gainsboroughhardware.com.au

Installation template
for dummy applications