

Installation Instructions for 9200 & 9400 Series Stainless Steel Leversets

(Purchase 480 or 960/980 latch).

Step 1.

- Fold template where indicated.
- Position template on door edge at desired latch height.
- Firmly hold template and mark latch height on door edge and handle fixing holes on door face at required backset (refer template).
- Measure door thickness and mark centre.
- Drill 25mm (1") latch hole through door edge.
- Note:** it is important to drill this hole squarely.
- Drill two 6.0mm (1/4") dia. holes and one 35mm (1 3/8") dia. hole through door face at required backset as marked on template.

Important Note
For mortice lock installation please refer to separate mortice lock installation sheet.

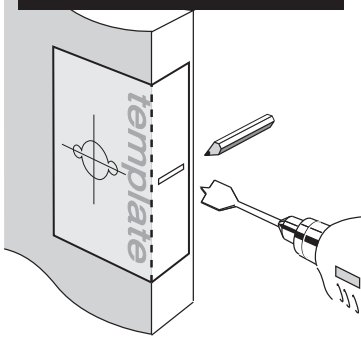

Important Note If installing a 9609 or a 9909 Privacy Adaptor with lever, refer to instructions included with Privacy Adaptor before commencing installation as this requires a 50mm diameter hole.

Step 2.

- Mark and chisel door edge for latch faceplate to a recess of 4.5mm or until flush with the door edge. Use latch faceplate as a template.
- Insert latch and fasten with wood screws provided.

Note: Use in conjunction with Gainsborough 480 or 960/980 Series Dual Sprung Tubular Latch – purchase separately.

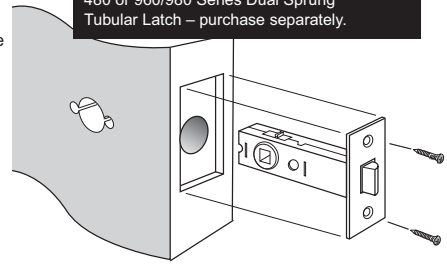

Step 3.

Install lever assemblies to door: 9200 & 9400 Series Stainless Steel Leversets

- Insert square drive spindle (1) through latch in door.
- Identify which side of the door each lever assembly will need to be located to allow both levers to move in a downward motion once installed.
- Remove rosette covers (2) from both lever assemblies.
- Place one lever assembly (3) onto the square drive spindle.
- Place other lever assembly (4) into position, locating it onto the other end of spindle.
- Fasten both lever assemblies together with screws provided (5): Use long screws for thick doors and short screws for thin doors. Each under-rose features a countersunk hole and a threaded hole.

9200

- Reapply rosette covers (2) to both under-roses by pushing the covers over the rubber rings until flush with door. The *grub-screw, which is already located in the rosette cover, should be on the lower face.
- Check the rosette covers are square with the door edge. Fasten in place with *grub-screw (6) using allen key (7) provided.

*Note: Grub-screw is already located in the rosette cover.

9400

- Reapply rosette covers (2) to both under-roses by pushing the covers over the rubber rings until flush with door. (Ensure tabs at bottom of under-rose match cut-out in rosette covers).

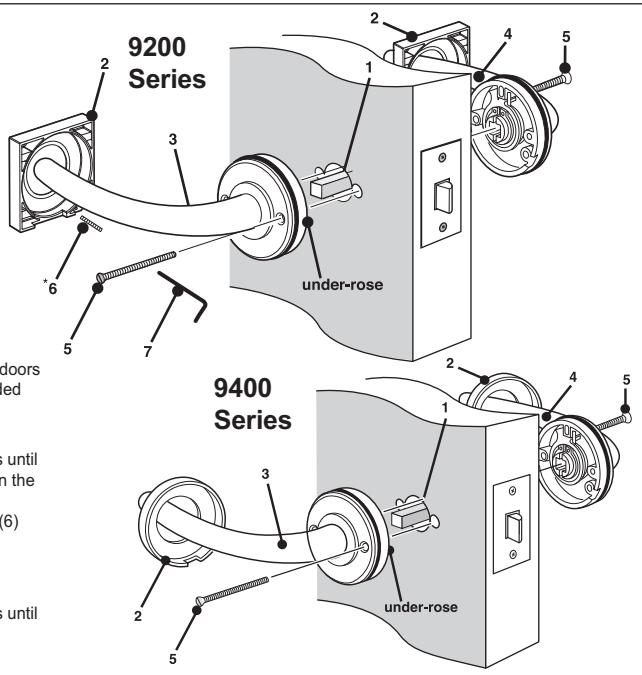

NOTE: Carefully follow these instructions when installing. Screws to be tightened to a recommended 2.5Nm torque.



Mark centre-line of latch hole
Mark centre-line of latch hole

Important Note

Do not drill 35mm hole if using privacy adaptor with this leverset. A privacy adaptor requires a 50mm diameter hole. See privacy adaptor installation instruction and template before commencing any drilling.

FOLD HERE

Fit here on door edge

Fit here on door edge

Important Note

Drill 6.0mm holes before 35mm hole for ease of drilling

6mm (1/4") hole (drill first)
35mm (1 3/8") hole (drill second)

BACKSET 60mm (2 3/8")

BACKSET 70mm (2 3/4")



Gainsborough Hardware Industries Limited,
Melbourne, Australia. A.B.N. 25 004 792 269
www.gainsboroughhardware.com.au

Separate Privacy Adaptors available:
• 9609 Privacy Adaptor suits 9400 Stainless Steel series.
• 9909 Privacy Adaptor suits 9200 Stainless Steel series.

Installation template for passage applications