

# Installation Instructions for Trilock Omni

### Step 1.

- Fold template where indicated.
- Position template on door edge at desired lock / latch height.
- Firmly hold template and mark latch height and 54mm (2 1/8") lock body hole centre.
- Measure door thickness and mark centre on 'latch height' marking.
- Drill 22mm (7/8") latch hole. NOTE: it is important to drill this hole squarely.
- Proceed onto drilling the 19mm (3/4") hole [suggest to drill pilot holes first at 6mm (1/4")] then enlarge to the correct size of 19mm, (3/4"), drilling from both sides of the door.
- Drill pilot hole for lock body [suggested size 3mm (1/8")]. Then enlarge hole to 54mm (2 1/8"), drilling from both sides of the door.

**Please note:** Ensure template position and orientation is as shown, incorrect installation voids warranty.

### Step 2.

- Mark and chisel latch faceplate to a recess of 2.5mm. Use latch carrier as a template.
- Insert lock body into 54mm (2 1/8") hole.
- Insert latch carrier through 22mm (7/8") hole into lock body assembly and fix with 2 screws.

**Ensure T-shaped hole at rear of latch carrier is upright!**

### Step 3.

- Check that tapered side of the latch bolt faces towards the door jamb, it may be necessary to un-clip the rear arm **A** of the latch bolt and rotate 180°, this is achieved by pushing the bolt **B** and arm **A** together and un-clipping.
- Insert the latch through the slot in the carrier until it can go no further.
- Insert the key and turn to retract the latch bolt.
- Ensure cardboard aligning template **C** is NOT removed from lock body.
- Install plastic faceplate shim **D** and faceplate, then screw into position.

**Do not remove** (If aligning template has been removed turn square spindle away from the latch bolt housing as far as it can go before inserting the latch bolt).

### Step 4. external spindle extraction

Note: In order for the external escutcheon (flat plate) to sit flat on the external door, half of the spindle is required to be removed. Please follow the following important steps with caution and take care performing the required tasks.

- Fit the supplied Tube Spanner to the section of the Spindle that is visible from the side the flat escutcheon is to be located (external side of door). Note: Ensure that you have selected the right side of the spindle before proceeding.
- Select a suitable screwdriver (not supplied) and insert it through the holes in Tube Spanner as shown in the diagram. Note: When fitting the screw driver make sure that the screwdriver handle is pointing towards the latch. If not, adjust the screwdriver and Tube Spanner to achieve this desired location, as displayed in the drawing.
- Important: Rotate the screwdriver handle in an upward direction only. As you rotate the screwdriver in the upward direction a section of the spindle will disengage and break free with the Tube Spanner.
- Remove the Tube Spanner and spindle remains.

### Step 5.

- Remove cut-outs from card-board template and place over lock body, making sure template is square to door edge.
- While holding template firmly in position, mark remaining 5 holes as indicated on both sides of the door (reversing template as required).
- Drill pilot holes from both sides of the door [suggested size 3mm (1/8")] then enlarge, again from both sides of the door, to sizes indicated on template.
- In particular, ensure the 54mm (2 1/8") dia. hole through door face (located above lock body hole) is drilled only to this size, otherwise correct functioning may be impeded – refer template.

### Step 6. to rehand internal lever & set lever operation

- Hold Trilock faceplate up to door to check lever orientation.
- To rehand lever, if required, insert flat blade screwdriver under handing-plate and twist.
- Rotate lever 180° toward bottom of faceplate, as shown, until it clicks into place.

### Step 7.

- Install posts to external faceplate (this is the flat plate with the vertical handle).
- Remove one of the stop screws (either SS1 or SS2) to allow the lever to operate in the downwards direction.

**Important note:** Remove the stop screw from the side that you require the handle to rotate towards.

### Step 8.

- Fit snib rotor onto large gear, on the inside of the internal faceplate (this is the one with the snib push-button).
- Position snib rotor so one notch faces up and the other notch points to the latch side.

Suits 35mm to 45mm door thicknesses

**NOTE:**

- carefully follow these instructions when installing.
- do not overtighten screws.
- use of power driver is not recommended.
- screws to be tightened to a recommended 2.5Nm torque.
- fully remove the Trilock prior to painting the door to avoid harming the product's finish.

3 IN 1 FUNCTION  
**TRILOCK**  
 DEADBOLT | LOCKSET | PASSAGE SET  
**OMNI SERIES**

# Installation Instructions for Trilock Omni

## Step 9.

- Insert spring and spindle in the square hole of the external lever. Mount outside faceplate to outside of the door, now mount the inside faceplate and align the two making sure the spindle engages with the snib rotor.
- Fit mounting screws from inside and tighten into threaded posts.

**NOTE: Test all functions for smooth operation.**

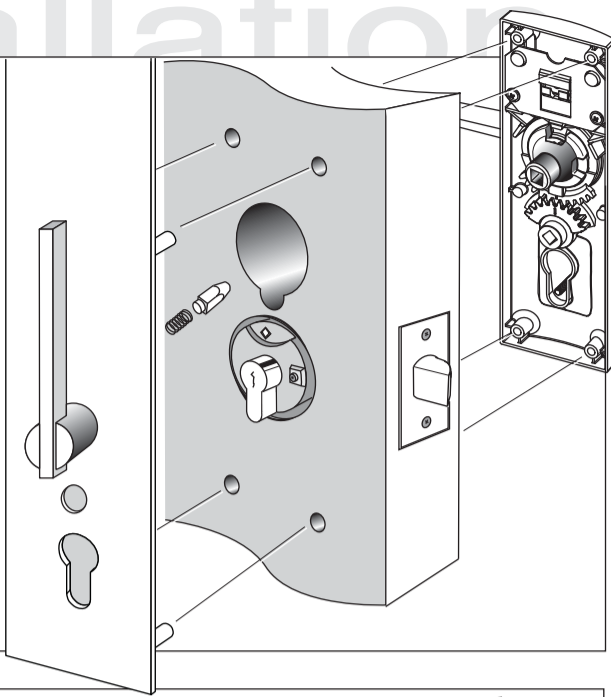

## Step 10.

- For single cylinder applications install internal turnbutton now by tightening grub-screw onto protruding shaft.

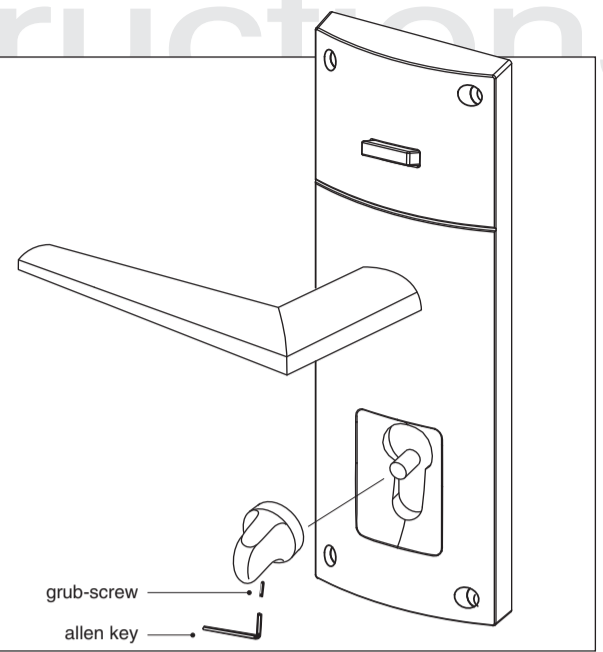

## Step 11.

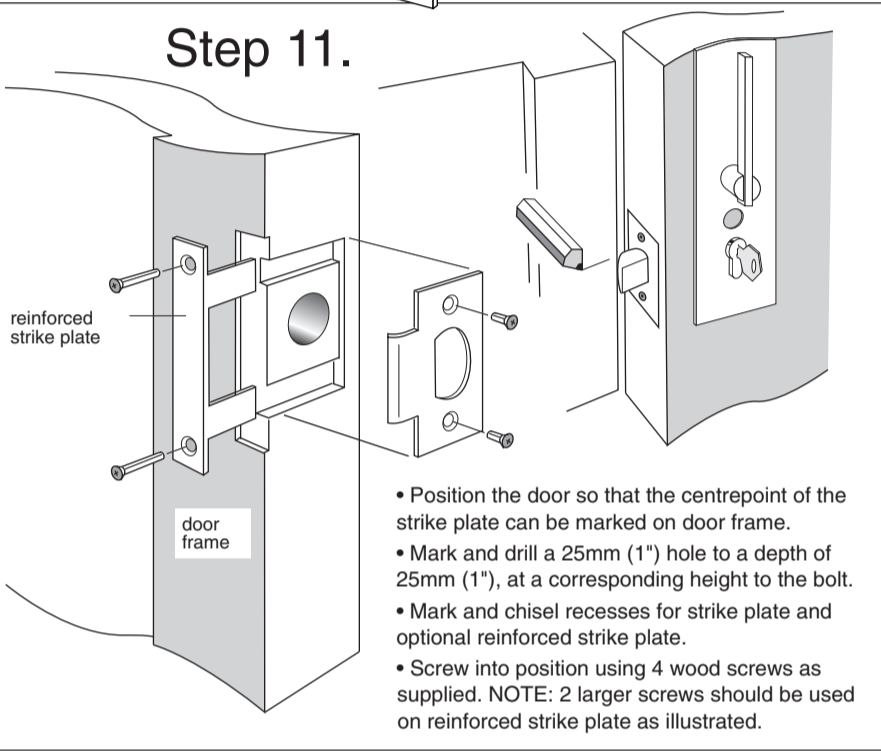

- Position the door so that the centrepoint of the strike plate can be marked on door frame.
- Mark and drill a 25mm (1") hole to a depth of 25mm (1"), at a corresponding height to the bolt.
- Mark and chisel recesses for strike plate and optional reinforced strike plate.
- Screw into position using 4 wood screws as supplied. NOTE: 2 larger screws should be used on reinforced strike plate as illustrated.

## Step 12. fixing of single pull handle

(Note: Suitable for solid doors only)

- Check and make sure that the outside faceplate is lined up straight and square with the door. Once the desired position of the outside faceplate has been confirmed, mark the centre of the hole at the top of the faceplate and proceed to drill a suitable hole.
- Note: When drilling the hole drill to a suitable depth ONLY to accommodate the coach screw (do not drill all the way through the door).
- On the side requiring the pull handle, hold the optional rectangular plastic washer centred over the hole against the door surface. Then hold the threaded bush onto the stainless steel, ensuring the larger section of the bush, as marked 'A' in illustration, is facing the door.
- Then, from the same side, install the 1/4" diameter coach screw through the threaded bush and optional plastic washer (if used) and into the door. Tighten coach screw securely with spanner.
- Place the two pull handle supports at each end of the pull handle over the top of the two bushes that are fitted to the door and faceplate. Line up the pull handle so that it is lined up straight and square. Insert the grub screws and tighten with allen key provided.

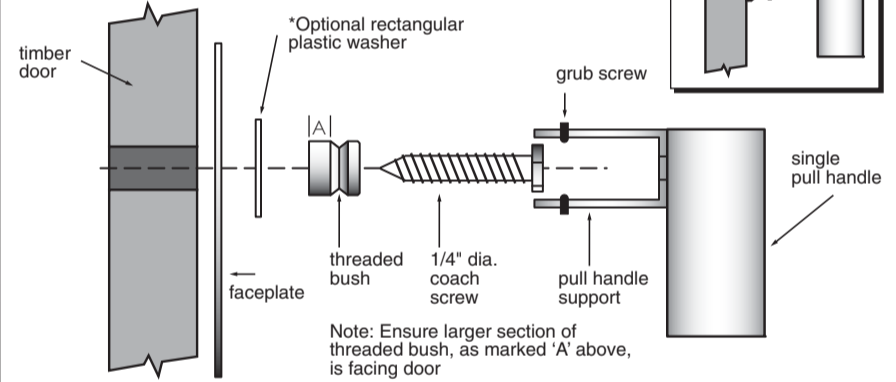

Note: Ensure larger section of threaded bush, as marked 'A' above, is facing door

Australian Patents: App. 662657 Plus other foreign patents

## Exploded Diagram

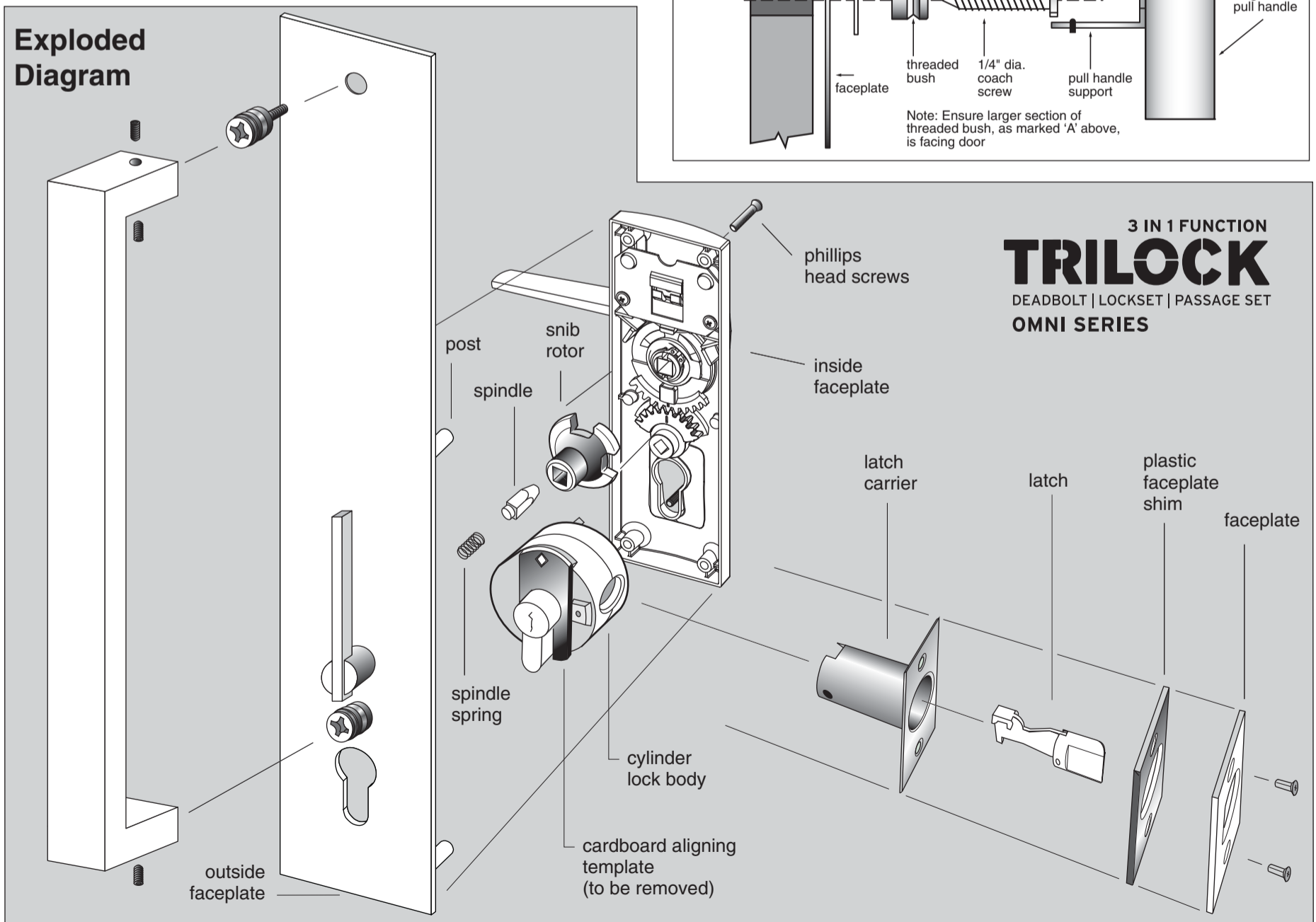

3 IN 1 FUNCTION  
**TRILOCK**  
DEADBOLT | LOCKSET | PASSAGE SET  
OMNI SERIES

Suits 35mm to 45mm door thicknesses