

Installation Instructions for Metaline/Leverline Series Handle Sets

for passage & privacy applications for new doors and/or doors with pre-drilled holes

Step 1.

- Place template on outside of door with height centre line approximately 97cm from the floor.
- Determine backset length and mark holes as shown for either a 60mm (2 3/8") backset or optional 70mm (2 3/4") backset.
- The holes to be marked are the centre 10mm diameter hole and the two 2mm diameter holes on either side of the centre hole.

Note: Check you have correct handed lever before beginning by ensuring the lever is pointing in the correct direction away from the door edge whilst the tip of the lever also curved downwards (refer illustration below). If alternative lever is required, please see your supplier.

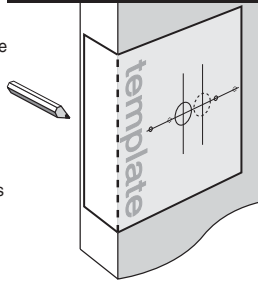

Note: The backset measurement is provided here to enable you to match the backset measurements used on other exterior or interior doors throughout the home or building. No latch is supplied nor required with this product.

Step 2.

- Drill the 10mm diameter hole through the door face.
- Then drill two only 2mm pilot holes approximately 5mm deep on the EXTERNAL side of the door ONLY, i.e. the side of the door to which the lever and fixing plate are to be installed to accommodate pull operation of the door.

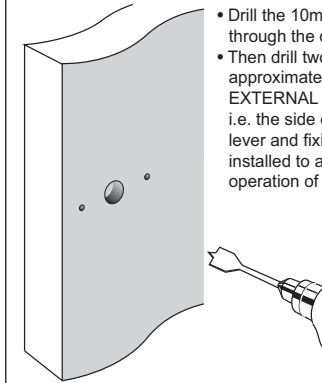

SNIB ASSEMBLY

Privacy locking snib must be on escutcheon inside room. Instructions to change snib to opposite side:

Step 1

Remove screw and saddle plate.

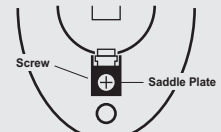

Step 2

Remove snib lever by pushing through hole.

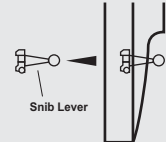

Step 3

Insert snib lever through hole in other back plate.

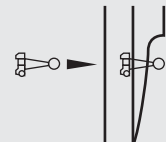

Step 4

Place saddle plate in position and fasten with screw.

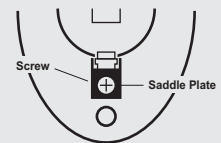

Step 3.

- Insert square drive through latch in door.

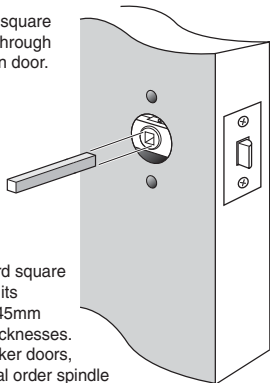

Note: Standard square drive suits 35mm-45mm door thicknesses. For thicker doors, a special order spindle may be used.

Step 5.

- Fasten internal and external lever/escutcheon assemblies together with screws provided.

Step 4.

- Insert blind screws and brass posts to the lever/escutcheon assembly chosen to fit the external door face.

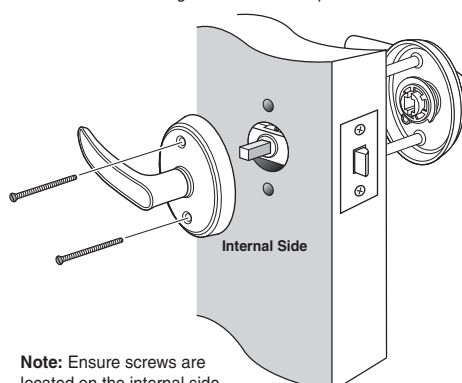
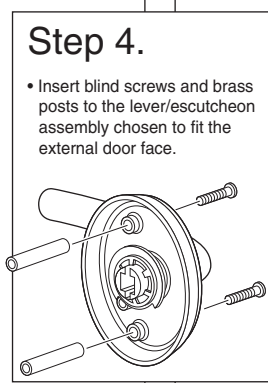

Note: Ensure screws are located on the internal side of the door.

NOTE: Carefully follow these instructions when installing. Screws to be tightened to a recommended 2.5Nm torque.



FOLD HERE

Mark centre-line of latch hole

Mark centre-line of latch hole

Fit here on door edge

Fit here on door edge

BACKSET 60mm (2 3/8")

BACKSET 70mm (2 3/4")

35mm (1 3/8") hole (drill second)
10mm hole (drill first)

6mm hole (For Privacy Set. Hole only required at bottom of assembly)

Gainsborough

Gainsborough Hardware Industries Limited
ABN 25 004 792 269
190 Whitehorse Road, Blackburn, Victoria 3130
www.gainsboroughhardware.com.au

When 54mm hole exists, disregard drilling instructions for 35mm (1 3/8") and 6mm (1/4") holes.

Note: To operate emergency release, insert sharp object into outside hole and push to unlock.